

labmodul

Designing safety

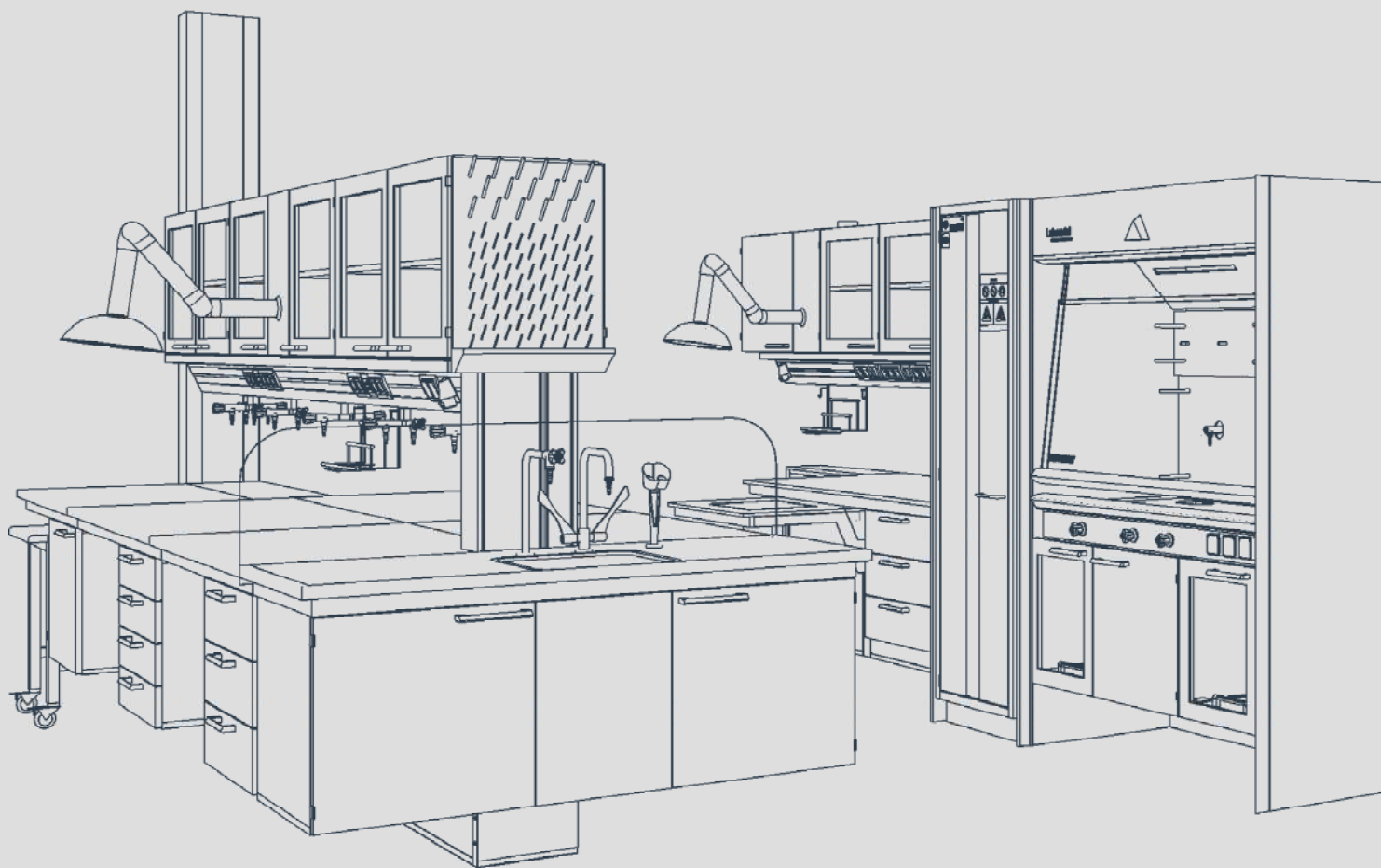

Designing safety...



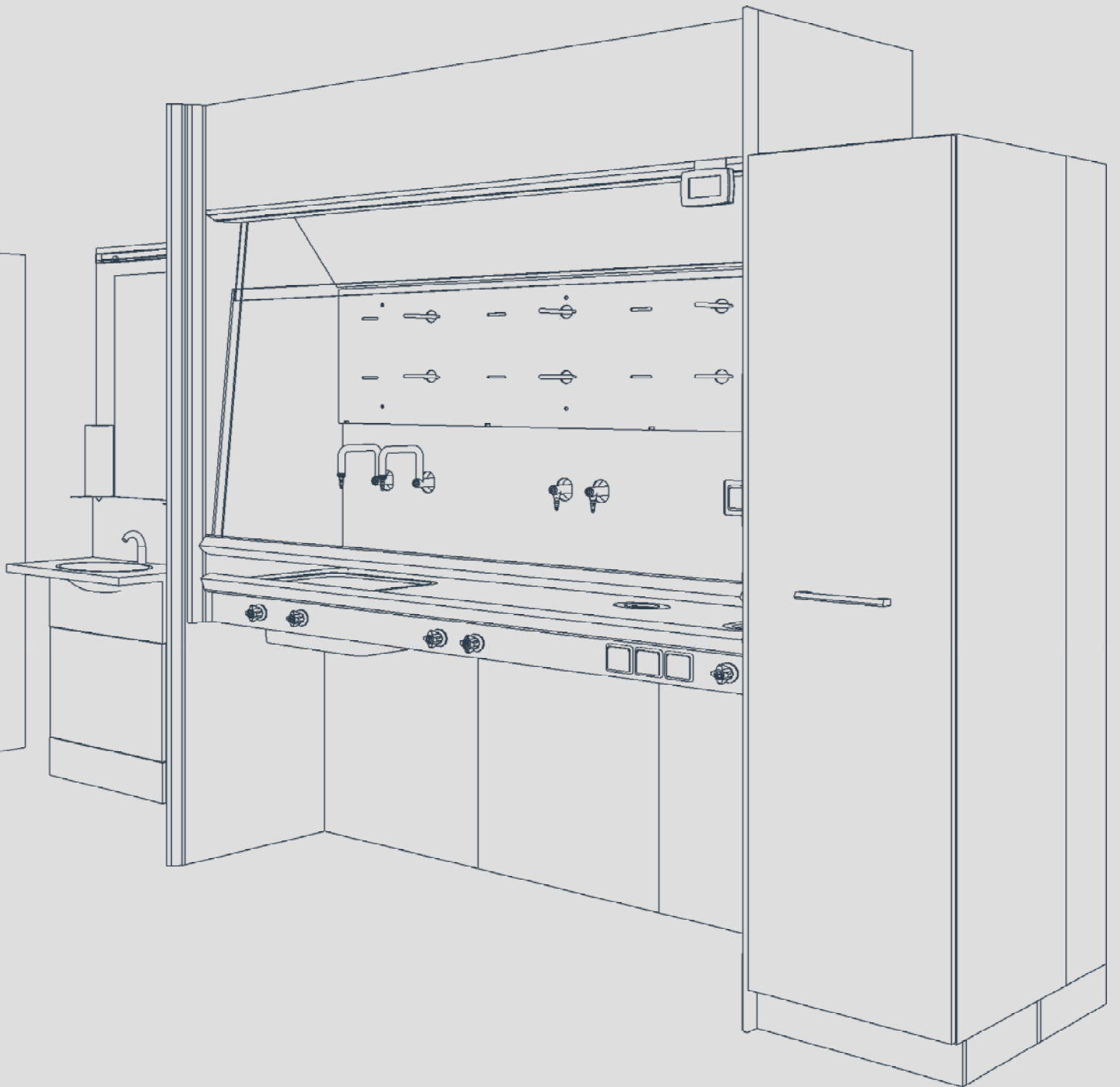

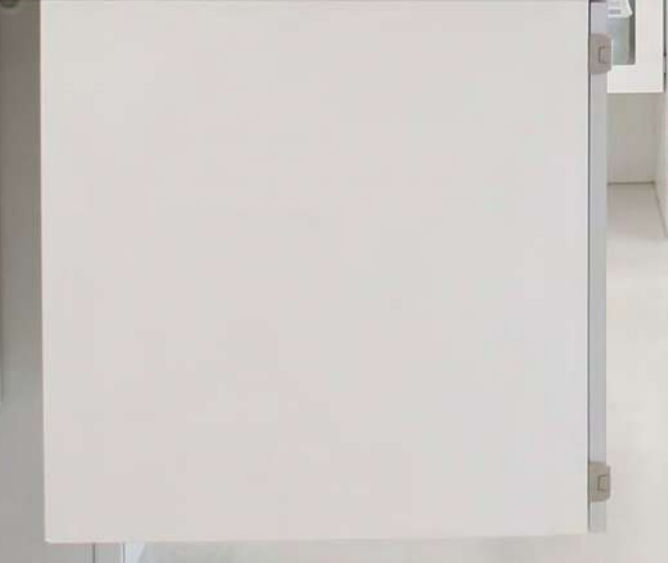



Suction unit built

For mixing or dispensing of medications we offer a suction unit, which elegantly integrated into a high cabinet. The Worktops is equipped with a drip tray in stainless steel, which can be removed for cleaning.

High cabinets with built-in suction unit is a practical solution also for such things as chemical storage. The appliance can be fitted to your requirements with ventilated cupboard, waste systems or just with general storage.

The cabinet is fully in context with all our storage and chemical cabinets.

The suction box is designed for adaptive furniture systems: System Create ISO 60/40, and System Storage.



Medicinskab med udsugning

	Dimension Width mm	Depth mm	Depth mm	Air flow m ³ /h
	650	650	650	300 m ³
	900			300 m ³



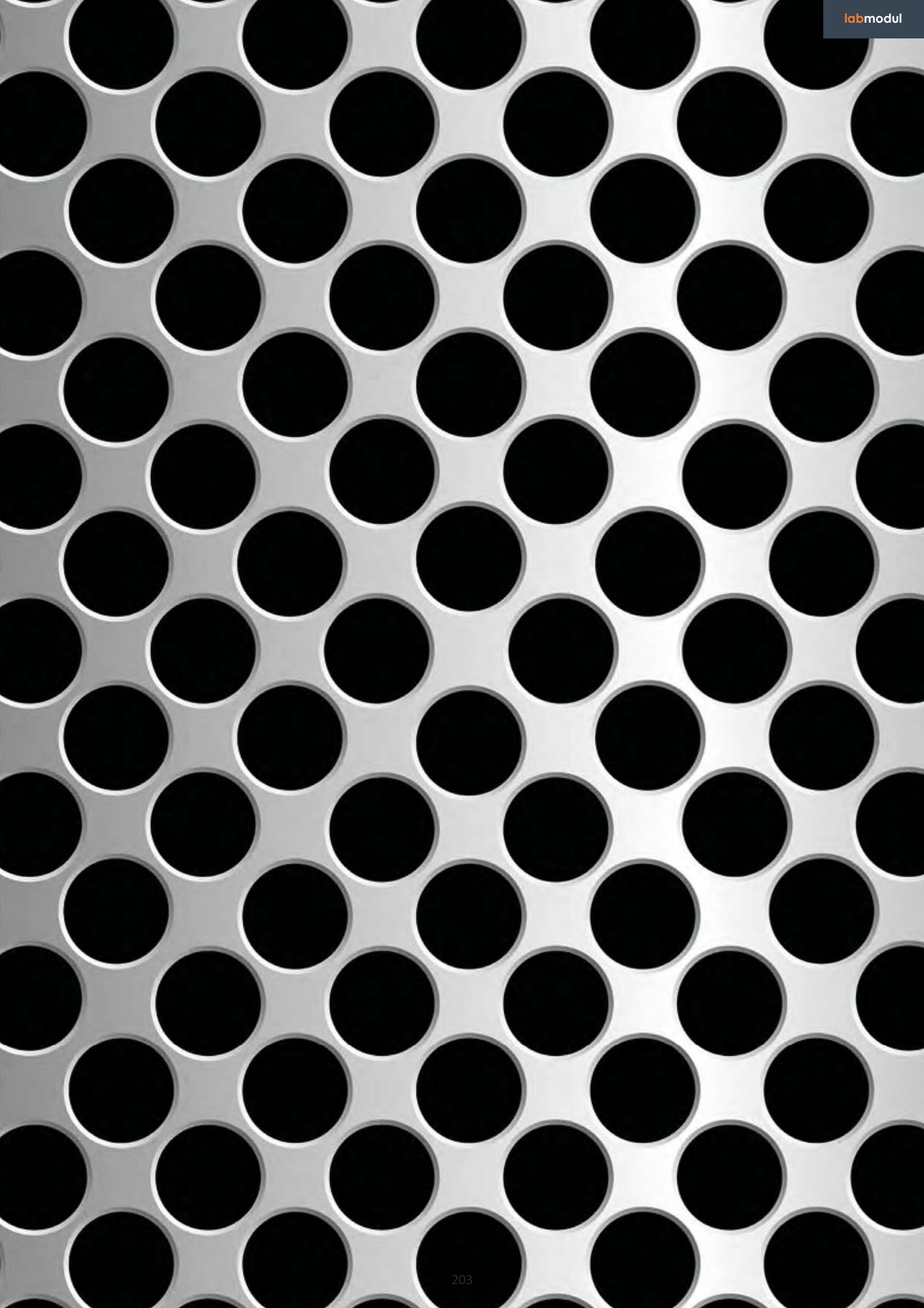

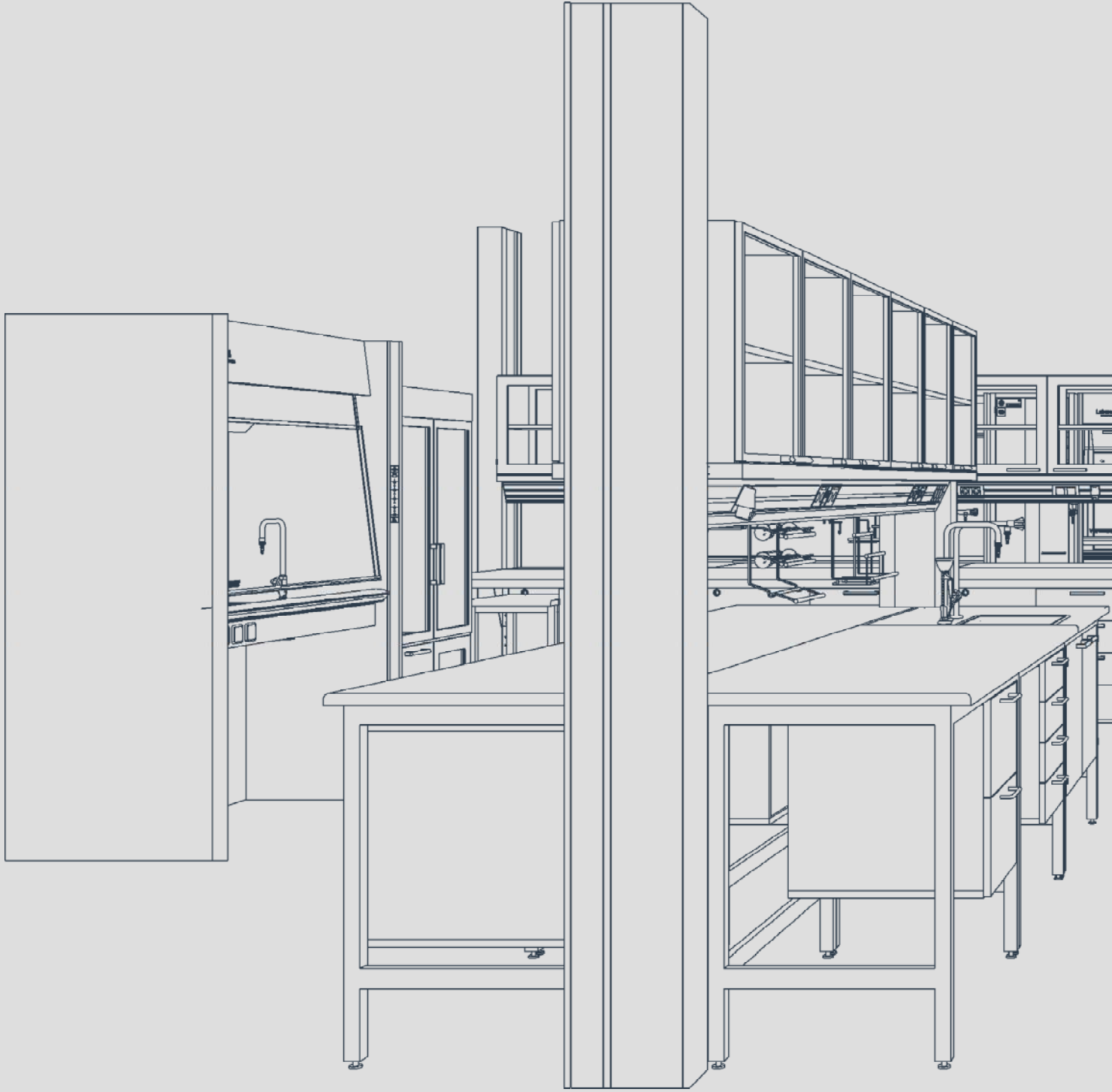

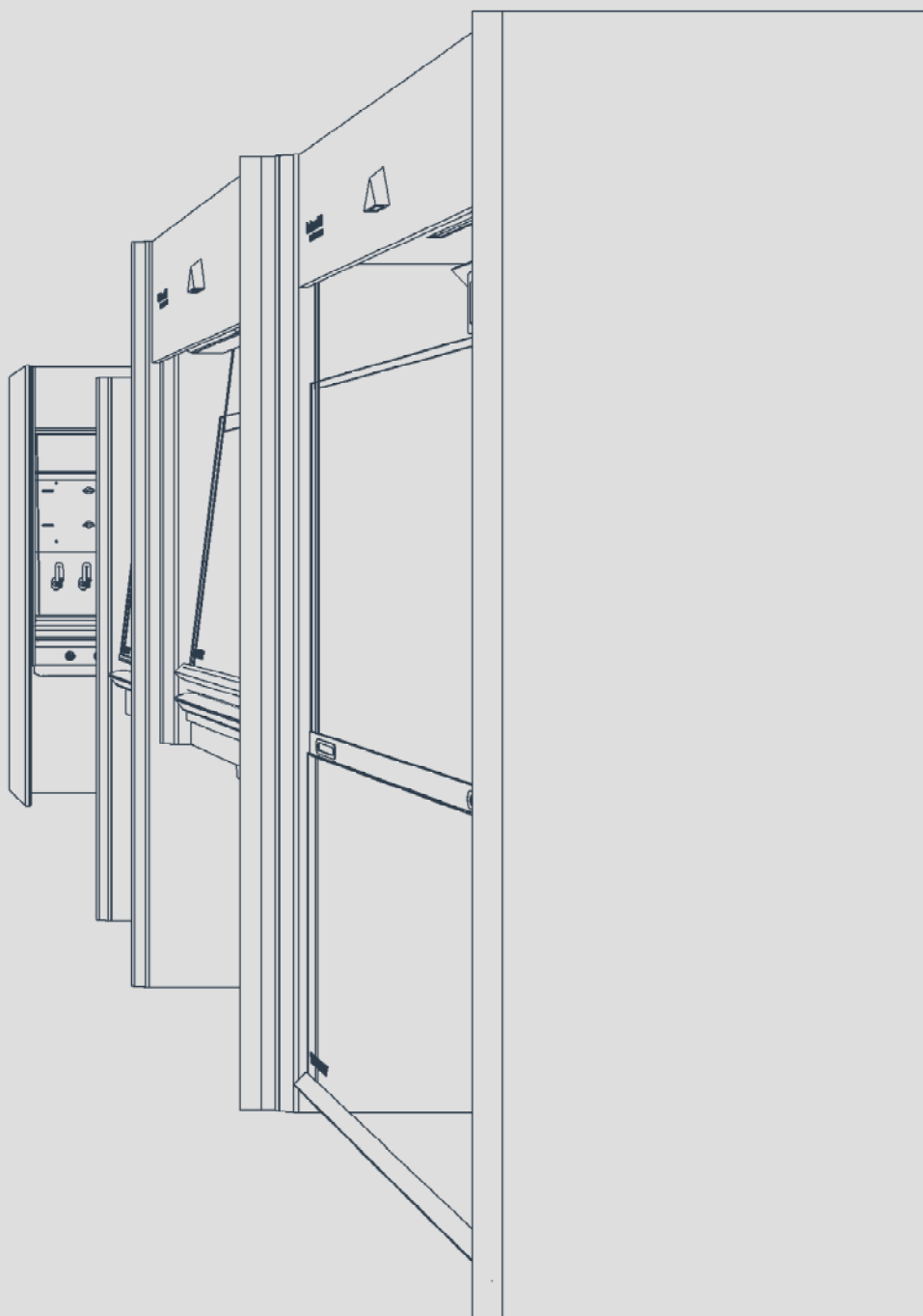
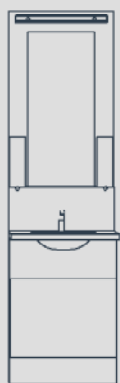



labmodul
Designing safety

Version: ★ ★ ★

LABMODUL A/S

Valhøjs alle 190
DK-2610 Rødovre
info@labmodul.dk